

MALVERN COLLECTIVE

| MELBOURNE |

TYPE 2CC

BEDROOM	2
BATHROOM	1
CARPARK	1

TOTAL AREA .....	91m <sup>2</sup>
Internal .....	74m <sup>2</sup>
External .....	17m <sup>2</sup>

APARTMENTS  
C103, C203, C403, C503, C603,  
C703, C803

- DW Dishwasher
- FC Fridge Cavity
- FR Fridge
- OC Outdoor Condenser
- PL Planter Box
- PS Privacy Screen
- R Robe
- S Storage
- WM Washing Machine
- WIR Walk-In-Robe

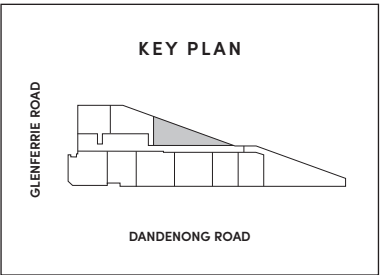
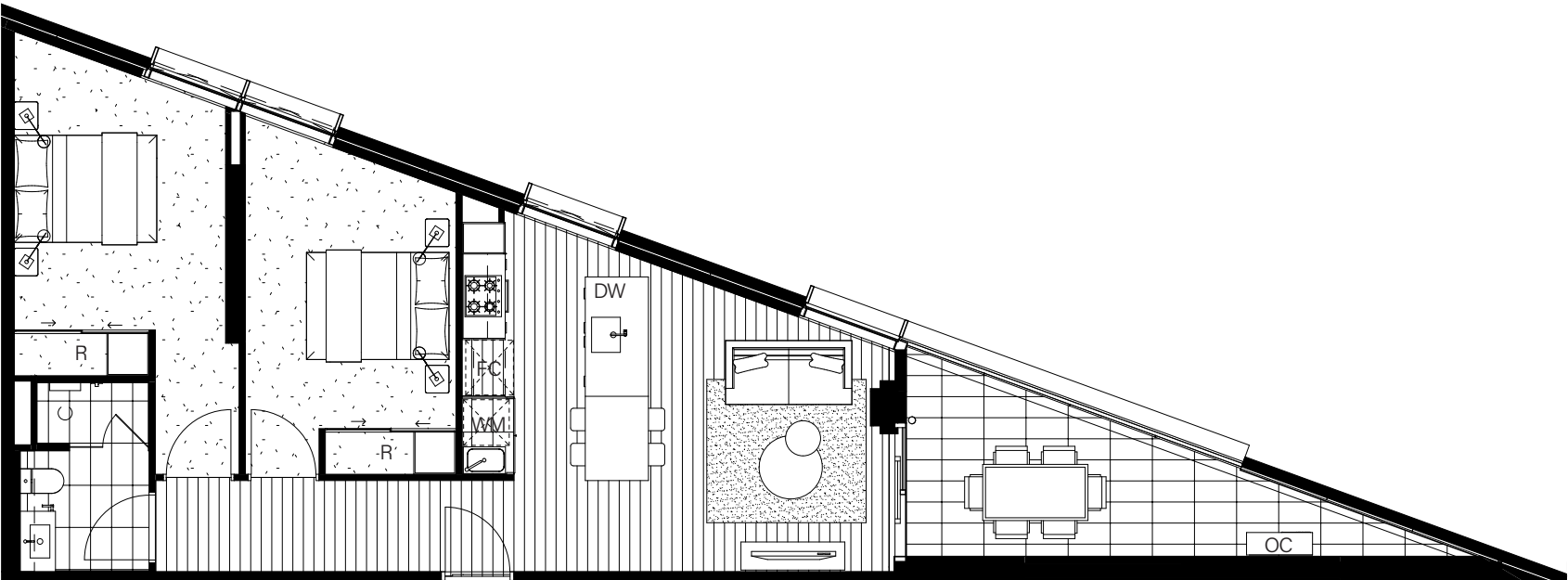

Disclaimer: This plan is indicative, not to scale and for illustrative purposes only. This representation is intended as a guide only and interested parties should refer to the specific apartment floor plan for further information and dimensions. The final product may differ from that illustrated, including changes to orientation, floor plan and layout. Furniture depicted is provided as a guide only and is not sold pursuant to the contract of sale. To the extent of any inconsistency between this floor plan and the building format plan, the building format plan prevails. These plans are subject to variation as set out in the contract of sale including resulting from design changes, approvals and final survey following completion of construction. Changes, including dimensions, specifications and fittings (including colours), will occur as the development progresses.



SCALE 1: 100

