

Sky Rise Residences
Stack 04 & 13
2 Bedroom 2 Bathroom

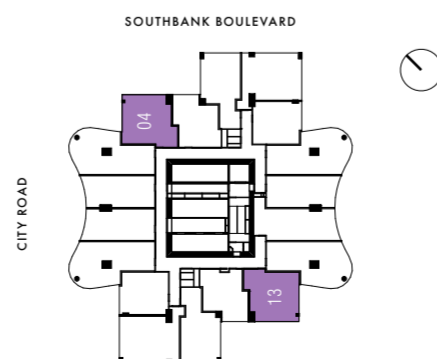

LEGEND

- | | | | |
|---|--------|----|-----------------|
| F | Fridge | DW | Dishwasher |
| P | Pantry | MW | Microwave |
| D | Dryer | WM | Washing Machine |

ASPECT VIEWS

- | | |
|----|-----------|
| 04 | City View |
| 13 | Bay View |

AREAS	INTERNAL		TOTAL	
Level 14-27	59.6 M ²	641.5 Ft ²	59.6 M ²	641.5 Ft ²
Level 28-41	59.7 M ²	642.6 Ft ²	59.7 M ²	642.6 Ft ²
Level 44-56	60.6 M ²	652.3 Ft ²	60.6 M ²	652.3 Ft ²
Level 57-67	60.6 M ²	652.3 Ft ²	60.6 M ²	652.3 Ft ²

Whilst we endeavour to ensure the contents of these plans are correct at the time of printing, the information they contain is to be used as a guide only. The columns shown on the plans may vary in diameter throughout the Building. All areas are provided in accordance with the Method of Measurement for Residential Property provided by the Property Council of Australia. The plans were completed prior to the completion of final design, engineering and construction of the Building, therefore design, engineering, dimensions, fittings, finishes and specifications are subject to change without notice in accordance with the provisions of the Contract of Sale. Photography may not reflect the actual apartment and to be regarded as indicative only. Please refer to your Contract of Sale.